



## UNIVERSAL CARB LINKAGE INSTALLATION INSTRUCTIONS

**3830G**

### Step 1

1. Insert pin "A" through hole in bracket "B".
2. Slide bracket "B" over rod "C".
3. Attach pin "A" to front carburetor using washers "D" and "E".
4. Insert cotter pin "F" to secure linkage to front carburetor.

### Step 2

1. Attach heim joint "G" to rod "C" and lock in place with nut. (Fine adjustments in linkage are made with the screw feature of the heim joint. It is suggested the "locking" step be performed last.)
2. Slide adapter "H" onto rod "I".
3. Attach heim joint "G" to adapter "H" by inserting bushing "J" and tightening with screw "K".
4. Place washer "L" on adapter "H" and insert through linkage arm on second carburetor.
5. Insert linkage bushing "M" on carburetor side of linkage arm and tighten with nut "N".

### PRIMARY ADJUSTMENT

- A. Attach adjustment bushing "O" to rod "C" for simultaneous carburetor opening. Slide bushing "O" on rod "C" until the bushing butts against bracket "B". Tighten screw-in bushing.
- B. For progressive carburetor opening, insert pin "A" through hole "P" on carburetor linkage arm on first carburetor only. Attach washers on pin "A" for spacers and insert cotter pin "F".

### FINE ADJUSTMENT

Adjust bushing "O" and lock nut on heim joint "G" until desired operation is achieved.

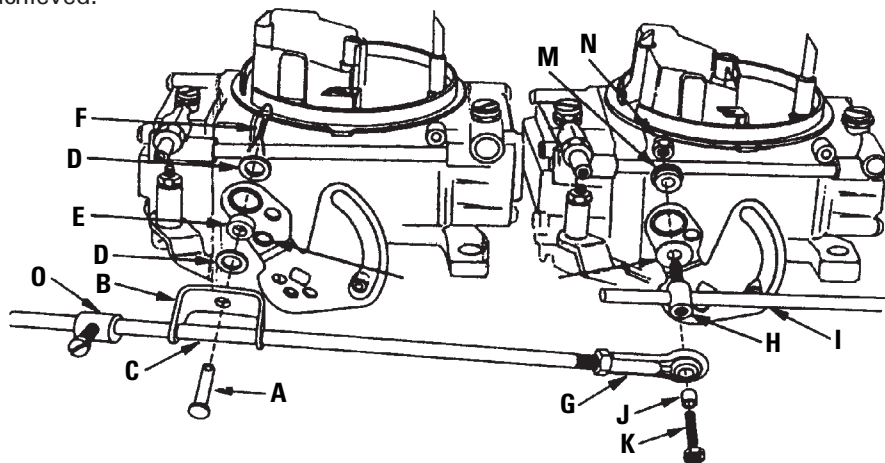
**PERFORMANCE GROUP®**

P/N 97143830

**Cleveland, Ohio 216.688.8300**
[www.mrgasket.com](http://www.mrgasket.com)

©2000